

Rowlands on Irving



Demographics: (2007 Estimate)

	1 Mile	3 Mile	5 Miles
2007 Population:	8,863	61,273	149,438
Median HH Income:	\$71,645	\$66,578	\$60,348
Traffic - Cars/Day:	Coors Blvd 67,200	Irving Blvd 18,400	Total 85,600

Coors Blvd & Irving Blvd Albuquerque, NM

Comments: Rare opportunity to purchase land within the “outer ring” of the Cottonwood Mall’s 1.2 million square feet of retail amidst Albuquerque’s blossoming Westside, less than 1 mile south of Westside Costco. This 3.99 acre site is situated in the heart of virtually every “power” retail tenant. It is an ideal location for junior anchors, restaurants and small shop space.

Size: 3.99 acres +/-

Sale Price: Call Broker

Area Tenants: Big 5, CostcoTarget, Home Improvement, Cottonwood Regional Mall, The Home Depot, Wal-Mart Super Center, and over 1.5 million square feet of additional retail.

John Sedberry
President

4700 Montgomery Blvd. NE
Suite 200
Albuquerque, NM 87119

(505) 855-7650
john@SedberryNM.com
www.sedberrynm.com

SEDBERRY & ASSOCIATES
COMMERCIAL REAL ESTATE SERVICES
A MEMBER OF
CHAINLINKS
RETAIL ADVISORS

Lisa K. Urrea
Senior Broker

4700 Montgomery Blvd. NE
Suite 200
Albuquerque, NM 87119

(505) 855-7650
lisak@SedberryNM.com
www.sedberrynm.com

SEDBERRY & ASSOCIATES
COMMERCIAL REAL ESTATE SERVICES
A MEMBER OF
CHAINLINKS
RETAIL ADVISORS

The information above has been obtained from sources believed reliable. While we do not doubt the accuracy, we have to verified it and make no guarantee, warranty or representation about it. It is your responsibility to independently confirm its accuracy and completeness. Any projections, opinions, assumptions or estimates used are for example only and do not represent the current or future performance of the property. The value of this transaction to you depends on tax and other factors which should be evaluated by your tax, financial and legal advisors. You and your advisors should conduct a careful, independent investigation of the property to determine to your satisfaction the suitability of the property for your needs.



SUBJECT

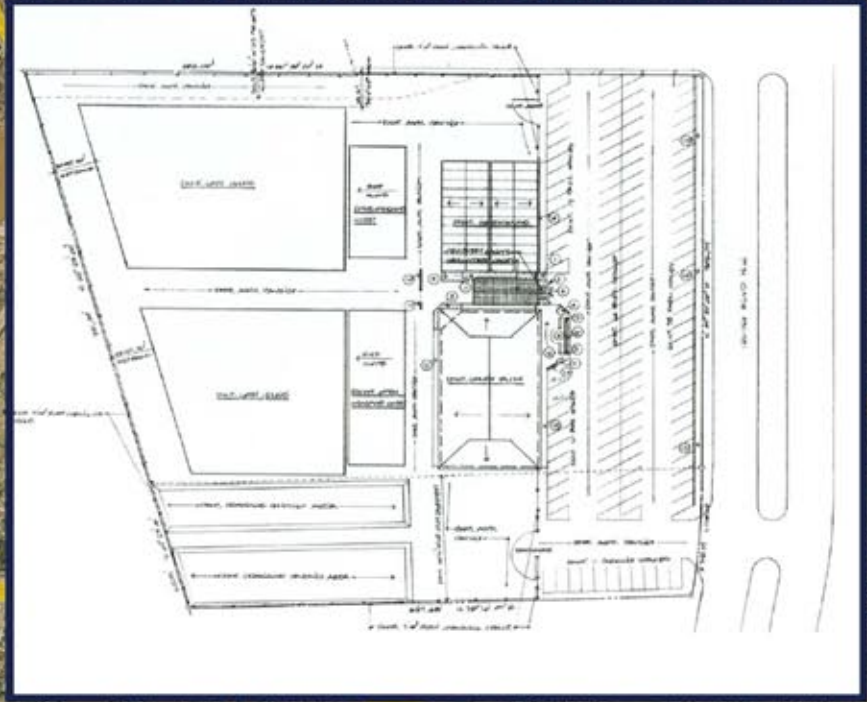

SEDBERRY & ASSOCIATES
 COMMERCIAL REAL ESTATE SERVICES
 A MEMBER OF
CHAINLINKS
 RETAIL ADVISORS

Lisa K. Urrea
 Senior Broker

4700 Montgomery Blvd. NE
 Suite 200
 Albuquerque, NM 87119

(505) 855-7650
 lisak@SedberryNM.com
 www.sedberrynm.com

SEDBERRY ASSOCIATES
 COMMERCIAL REAL ESTATE SERVICES
 A MEMBER OF
CHAINLINKS
 RETAIL ADVISORS

John Sedberry
 President

4700 Montgomery Blvd. NE
 Suite 200
 Albuquerque, NM 87119

(505) 855-7650
 john@SedberryNM.com
 www.sedberrynm.com

The information above has been obtained from sources believed reliable. While we do not doubt the accuracy, we have to verified it and make no guarantee, warranty or representation about it. It is your responsibility to independently confirm its accuracy and completeness. Any projections, opinions, assumptions or estimates used are for example only and do not represent the current or future performance of the property. The value of this transaction to you depends on tax and other factors which should be evaluated by your tax, financial and legal advisors. You and your advisors should conduct a careful, independent investigation of the property to determine to your satisfaction the suitability of the property for your needs