

Dollar Tree Plaza



1742 W. Maloney St Gallup, NM

Demographics: (2007 Estimate)
3 Mile **5 Miles** **10 Miles**

Population:
 36,777 45,208 52,594

Median HH Income:
 \$33,320 \$36,369 \$35,751

Area Tenants: Wal-Mart Super Center, Home Depot, Carls Jr., Dollar Tree, Radio Shack, Sally Beauty, Cato Fashions, Game Stop

Comments: Anchored by the Walmart Super Center with visibility from I-40

Building Area: Approximately 2,827 sqft. +/-

Grant Wilson
 Associate Broker

4700 Montgomery Blvd. NE
 Suite 200
 Albuquerque, NM 87119

(505) 855-7650

grant@SedberryNM.com
 www.sedberrynm.com

SEDBERRY & ASSOCIATES
 COMMERCIAL REAL ESTATE SERVICES
 A MEMBER OF
CHAINLINKS
 RETAIL ADVISORS

The information above has been obtained from sources believed reliable. While we do not doubt the accuracy, we have to verified it and make no guarantee, warranty or representation about it. It is your responsibility to independently confirm its accuracy and completeness. Any projections, opinions, assumptions or estimates used are for example only and do not represent the current or future performance of the property. The value of this transaction to you depends on tax and other factors which should be evaluated by your tax, financial and legal advisors. You and your advisors should conduct a careful, independent investigation of the property to determine to your satisfaction the suitability of the property for your needs.

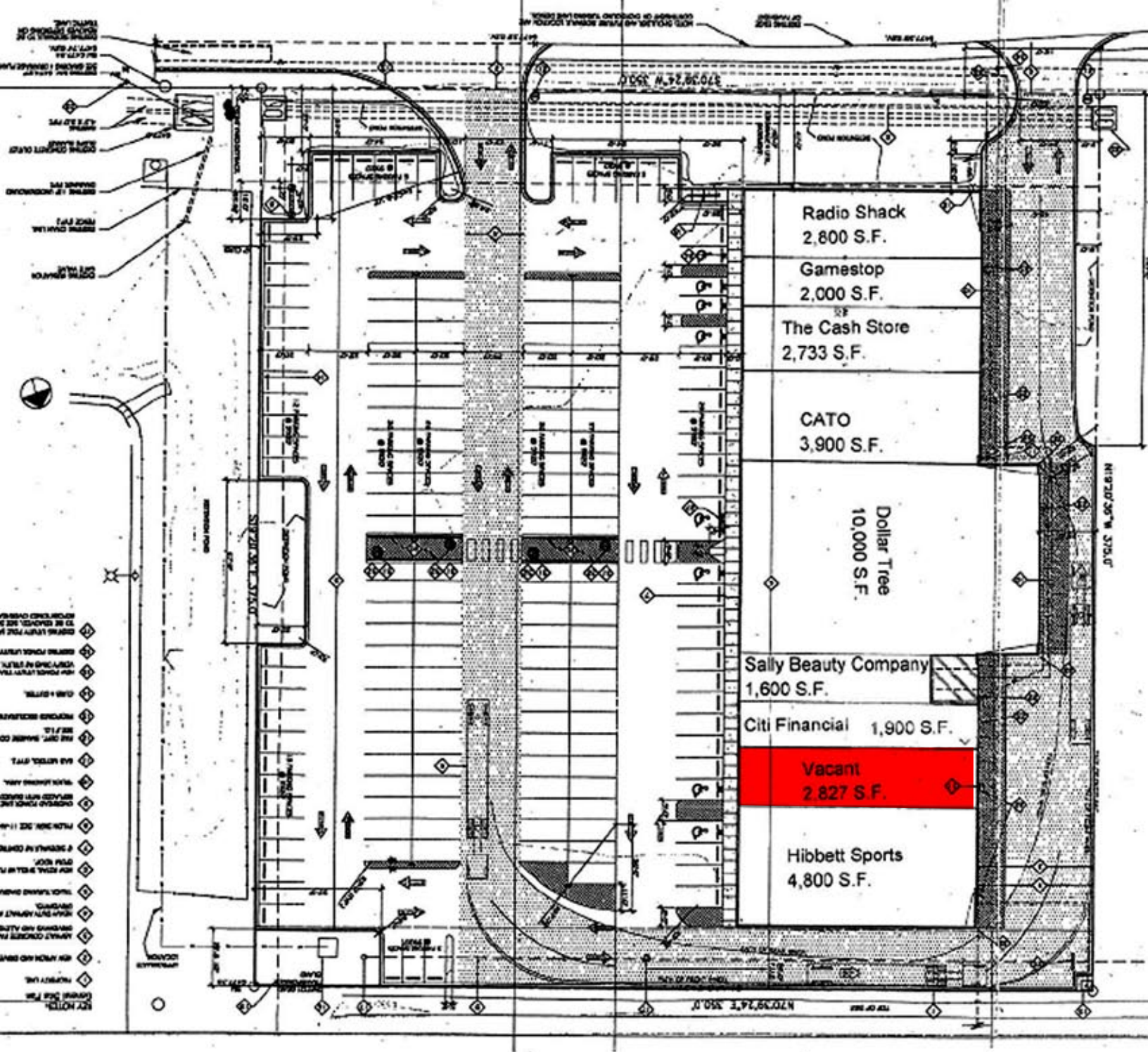

Grant Wilson
Associate Broker

4700 Montgomery Blvd. NE
Suite 200
Albuquerque, NM 87119

(505) 855-7650

grant@SedberryNM.com

www.sedberrynm.com

SEDBERRY & ASSOCIATES
COMMERCIAL REAL ESTATE SERVICES
A MEMBER OF
CHAINLINKS
RETAIL ADVISORS



Walmart
Save money. Live better.

The information above has been obtained from sources believed reliable. While we do not doubt the accuracy, we have to verified it and make no guarantee, warranty or representation about it. It is your responsibility to independently confirm its accuracy and completeness. Any projections, opinions, assumptions or estimates used are for example only and do not represent the current or future performance of the property. The value of this transaction to you depends on tax and other factors which should be evaluated by your tax, financial and legal advisors. You and your advisors should conduct a careful, independent investigation of the property to determine to your satisfaction the suitability of the property for your needs.